

| N° Object | Code | Description | Qty | N° Object | Code | Description | Qty |
|-----------|--------|---|-----|-----------|--------|--|-----|
| 18 | 400006 | Protection door | 4 | 6153 | ZC0333 | Profile control panel drawer 90 Ascot internal black | 1 |
| 98 | 481913 | Terminal block for oven 32 PA 233 | 1 | 6215 | ZP0425 | Support for fan timelag device | 1 |
| 1014 | ZS2026 | Thermostat TY60 N.O. fixing B | 1 | 6254 | ZP0467 | Lower guard for hob 90 ascot | 1 |
| 1414 | ZS2601 | Terminal board support | 1 | 6255 | ZP0468 | Rear guard for hob 90 Ascot | 1 |
| 1439 | ZS2663 | Cooling fan L=180 Plaset (AU) | 1 | 6305 | ZP0394 | Profile control panel drawer 90 Ascot external inox | 1 |
| 1575 | ZS2931 | Spacer between glasses | 2 | | | | |
| 1606 | ZS2995 | Fixing spring for front profile | 16 | | | | |
| 1944 | ZS2719 | Air conveyor for cooktop 090/100 Prb/Drb | 1 | | | | |
| 1999 | ZS3184 | Back splash for cooker 90 Ascot | 1 | | | | |
| 2024 | ZS3305 | Fixing plate for top Ascot | 2 | | | | |
| 3682 | ZS5929 | Upper lateral panel right/left side only TOP Ascot inox | 2 | | | | |
| 4064 | ZS6376 | Support for internal support control panel 90 Ascot | 1 | | | | |
| 4243 | ZS6724 | Ramp hole closing plate | 1 | | | | |
| 4266 | ZS6787 | Encoders control board | 1 | | | | |
| 4316 | ZS6567 | Control panel front 5/6 burners Ascot top 90 S.STEEL | 1 | | | | |
| 5082 | ZS7958 | "Steel - Stile in cucina" plate | 1 | | | | |
| 5189 | ZS8173 | Handle for hob cooker Ascot 90 chromed terminal nickel | 1 | | | | |
| 5783 | ZS6817 | Feet for electronic components EGO | 3 | | | | |
| 5784 | ZS6904 | Cover for induction terminal board | 1 | | | | |
| 5785 | ZS6905 | Bridge for induction terminal board | 1 | | | | |
| 6036 | ZS8446 | Clamp support for induction 90/100 Sintesi front / rear | 2 | | | | |
| 6039 | ZS8880 | Support for electronic control induction element | 1 | | | | |
| 6071 | ZA0469 | Induction 5 element OCTA EGO 75.08016.610 | 1 | | | | |
| 6097 | GP0204 | Assembly cooktop cooker 90 induction Ascot OCTA | 1 | | | | |
| 6069 | ZA0467 | Glass for 90 induction hob or cooker | 1 | | | | |
| 1957 | ZS3495 | Washer 4.3 x 10 x 3 | 4 | | | | |
| 5038 | ZS7683 | Complete upper right side Ascot VTRC/IND | 1 | | | | |
| 5039 | ZS7684 | Complete upper left side Ascot VTRC/IND | 1 | | | | |

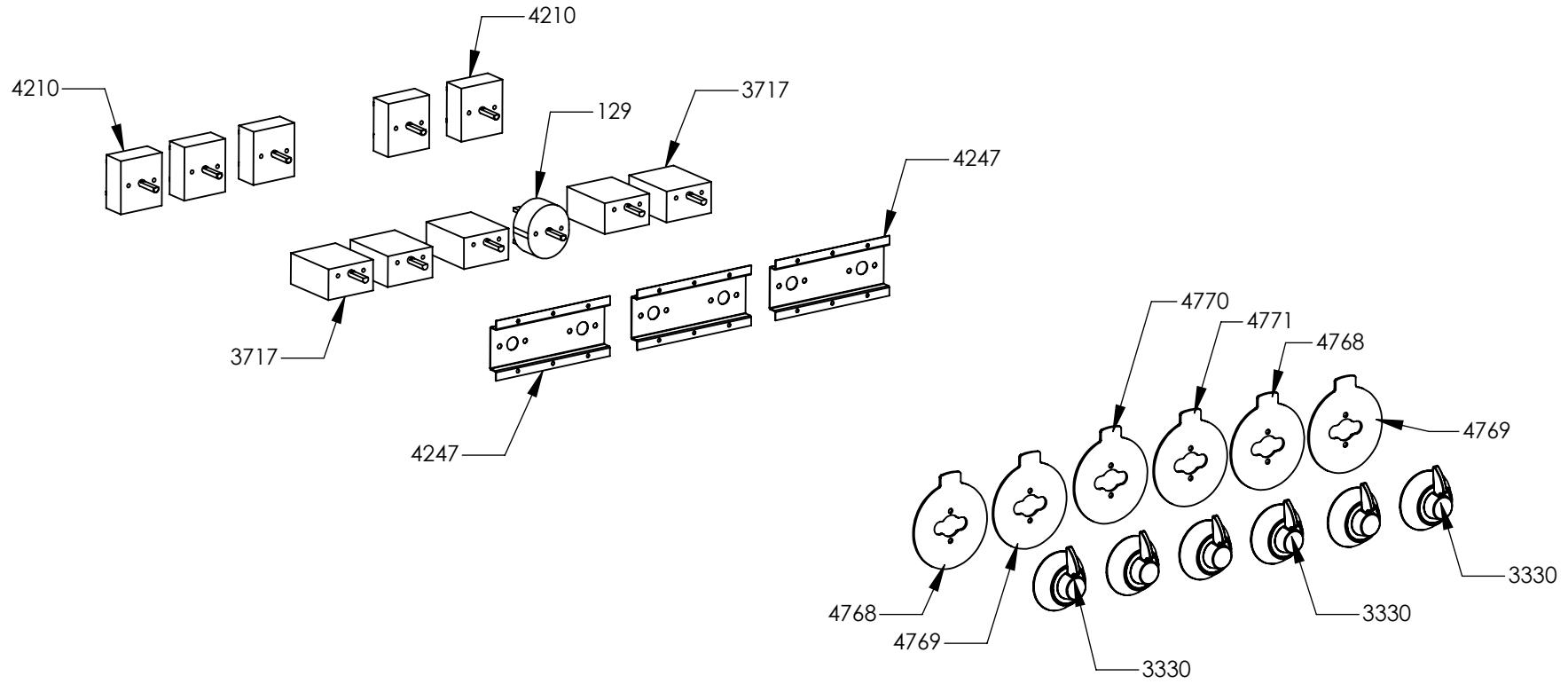

| N° Object | Code | Description | Qty |
|-----------|--------|---|-----|
| 129 | 601154 | Timer | 1 |
| 3330 | ZS5412 | Ascot chromed knob | 6 |
| 3717 | ZS6026 | Switch for induction encoder | 5 |
| 4210 | ZS5377 | Energy regulator for induction 230 V EGO EU | 5 |
| 4247 | ZS6732 | Commutator support 2 positions | 3 |
| 4768 | ZS7469 | Bezel for front induction knob Ascot | 2 |
| 4769 | ZS7470 | Bezel for rear induction knob Ascot | 2 |
| 4770 | ZS7471 | Bezel for central induction knob Ascot | 1 |
| 4771 | ZS7472 | Bezel for timer knob Ascot | 1 |

| N° Object | Code | Description | Qty |
|-----------|--------|--|-------|
| 725 | 601108 | Anti-overturning device | 0,3 |
| 1329 | ZS5150 | Adhesive tape 33 mt x 25h mm x Th 1.55 mm (3M) | 15000 |
| 5050 | ZS7813 | Instruction booklet Top/Cooker Multilanguage | 1 |
| 6252 | ZA0640 | Wiring diagram for hob S9-6l | 1 |